

JISIM[®]

User Instruction

Smart Panel Remote Controller

Model No.: SM-PE1_SM-PE2_SM-PE3_SM-PE4

SM-PW1_SM-PW2_SM-PW3_SM-PW4

1. Product Features

Smart Panel Remote Controller is a newly developed remote controller. This Panel remote controller is designed by a delicate and fashionable tempered glass panel; And we adopt a high precision Capacitive touch screen IC. Touch Screen is very stable; 2.4GHz high RF wireless control with long distance controlling, low power consumption and high speed transmitting rate. This product has SM-PW series and SM-PE series, and the difference is the method of power supplying. Both series have 4 kinds: SM-PE1/SM-PW1 4-zone dimmable panel remote controller; M-PE2/M-PW2 CCT 4-zone panel remote controller; SM-PE3/SM-PW3 4-zone RGB/RGBW panel remote controller; SM-PE4/SM-PW4 4-zone RGB+CCT panel remote controller. This product widely work on our smart LED Lighting, LED Controller and Smart panel controller, etc.

Panel Remote Controller Name	Compatible Remote Model	Compatible products
4-Zone Brightness Dimming Panel Remote Controller	SM-R089	Brightness dimming series
4-Zone CCT Adjust Panel Remote Controller	SM-R089	CCT adjust series
4-Zone RGB/RGBW Panel Remote Controller	SM-R089	RGB / RGBW series
4-Zone RGB+CCT Panel Remote Controller	SM-R089	RGB / RGBW RGB+CCT series

2. Technical Parameters

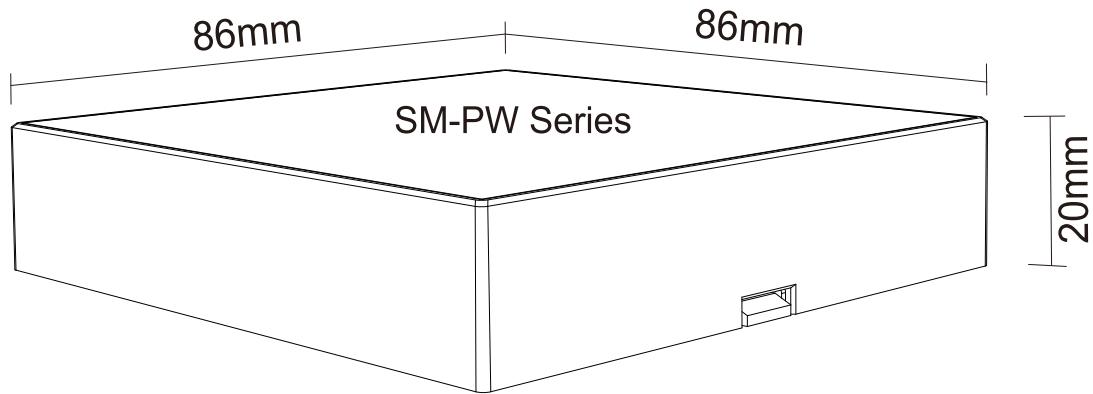

SM-PW Series: Powered by 3V(2*AAA Battery)

Working Temperature: -20-60°C

Input Voltage: 3V(2*AAA Battery)

Radio Frequency: 2400-2483.5MHz

Modulation Method: GFSK

Transmitting Power: 6dBm

Control Distance: 30m

Standby Power: 20uA

Size: L86mm*W86mm

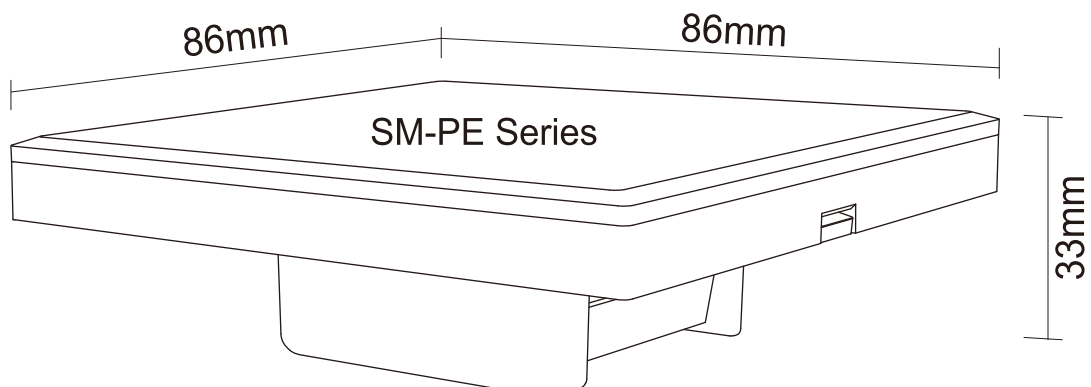

SM-PE Series: Powered by AC90-110V or AC180-240V

Working Temperature: -20-60°C

Input Voltage: AC90-110V or AC180-240V

Radio Frequency: 2400-2483.5MHz

Modulation Method: GFSK

Transmitting Power: 6dBm

Control Distance: 30m

Size: L86mm*W86mm

3. Installation/ Dismantlement

SM-PE series Installation/ Dismantlement

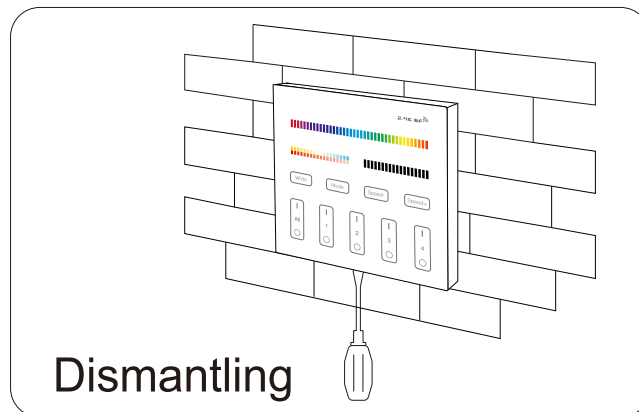
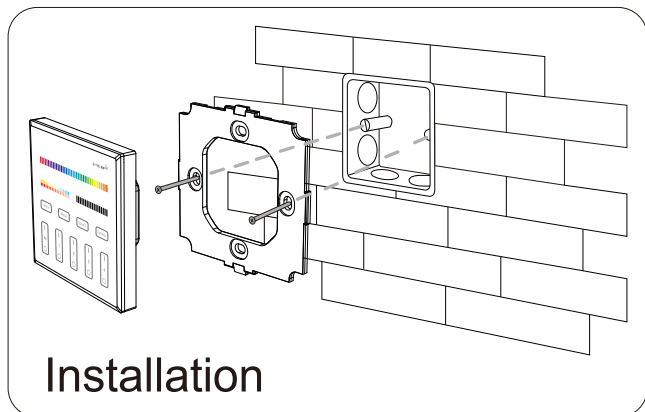

SM-PW series Installation/ Dismantlement

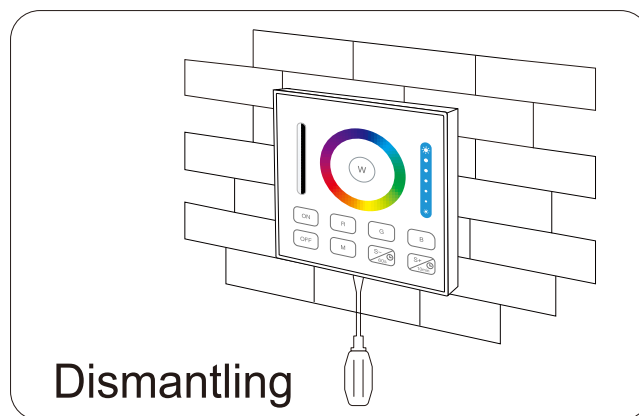
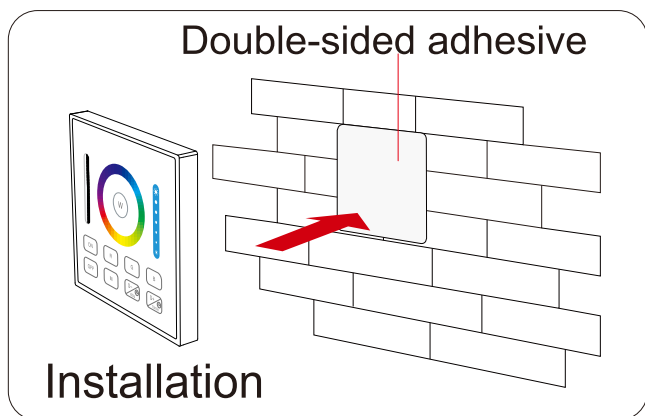

4. Attention

1. Please check the cable, and make the circuit is correct before power on.
2. When installation, pls handle with care to avoid the broken of the glass panel.



www.jisim-tech.com

Made in China



5. Function of keys

When touching the button, LED indicating lamp will
Remark:

flash once with different sound(Touch slider with no sound).

SM-PW1&SM-PE1

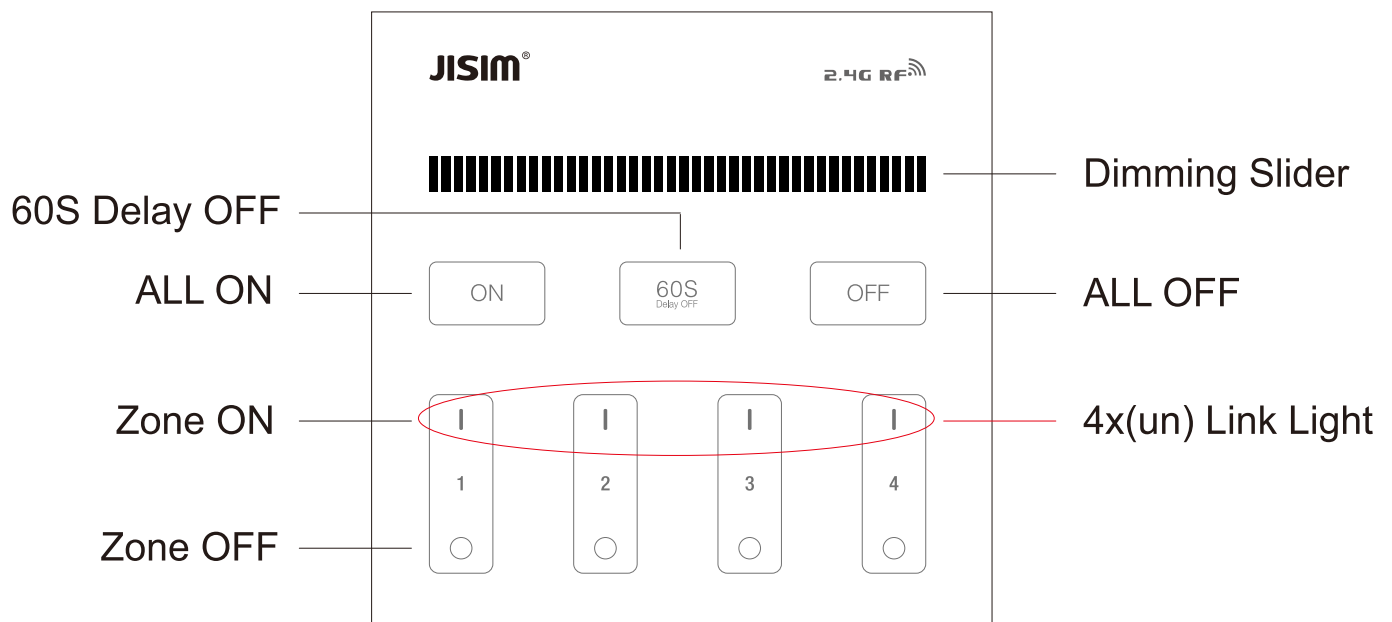

SM-PW2&SM-PE2

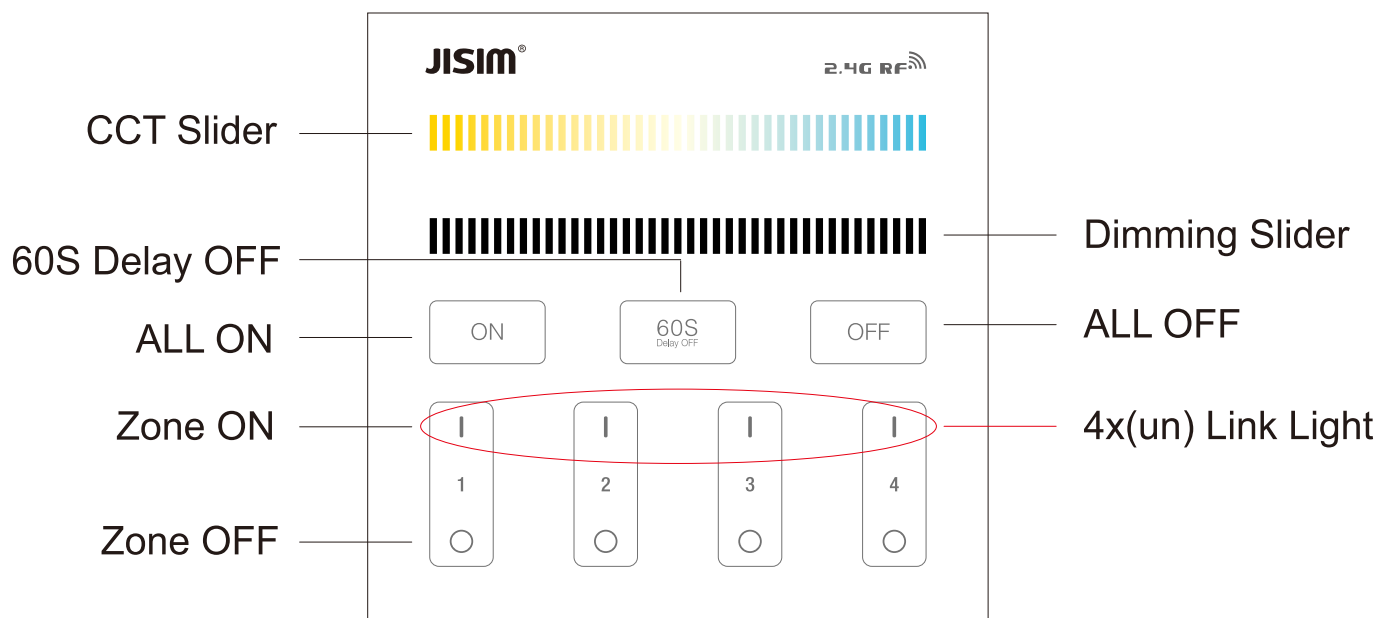

 Touch the slider to change color temperature.

 Touch Dimming Slider to change the brightness from 1~100%.

 Touch Master ON, Turn on all linked lights.
Long press 5 seconds to turn ON the indicating sound.



When the light is ON, press "60S Delay OFF", the light will be OFF Automatically after 60 seconds.



Touch Master OFF, Turn off all linked lights.
Long press 5 seconds to turn OFF the indicating sound.



Touch Zone ON, Turn on zone-linked lights.



Touch Zone OFF, Turn off zone-linked lights.

SM-PW3&SM-PE3

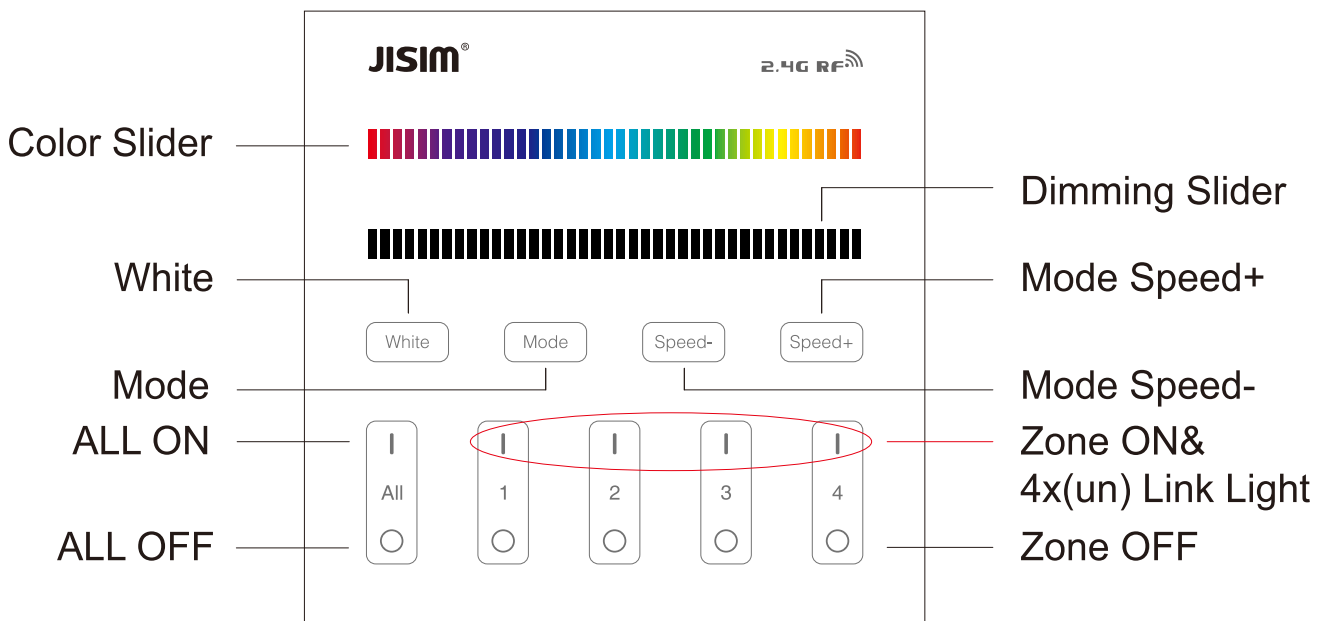

SM-PW4&SM-PE4

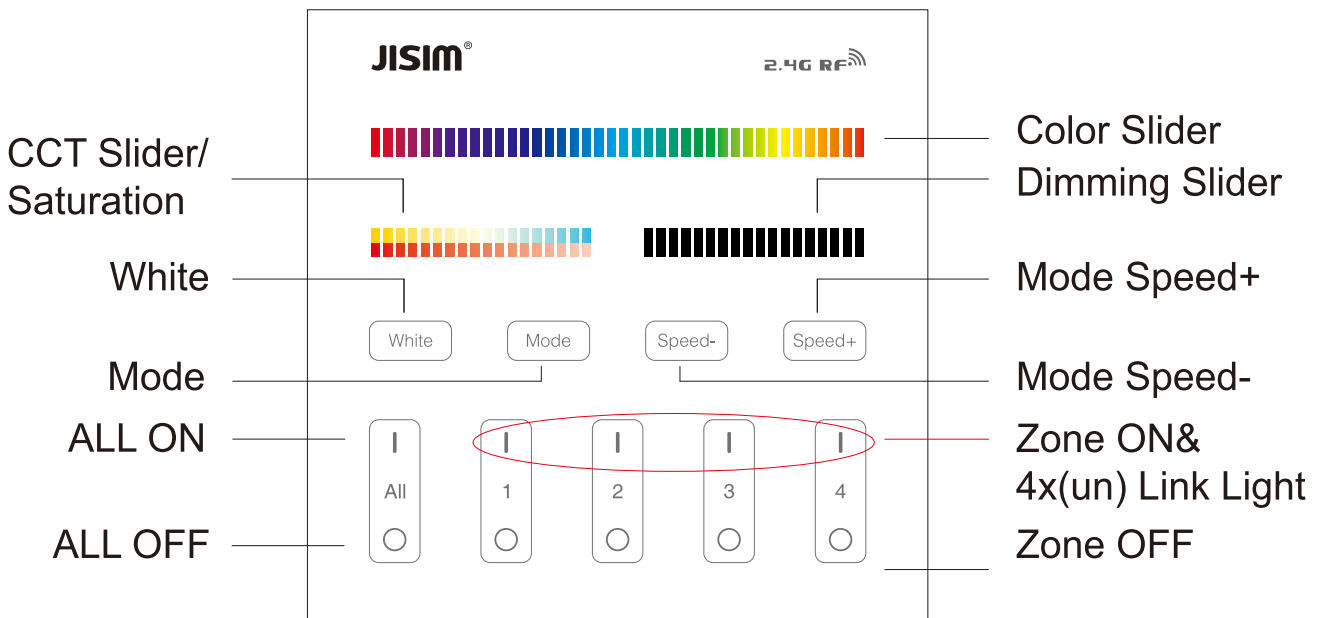

 Touch Color Slider, Choose the color you want.

 Touch Dimming Slider to change the brightness from 1~100%.

 Touch White button to white light mode.

 Switching Modes.

 Slow the speed on present dynamic mode.

 Accelerate the speed on present dynamic mode.

 ALL ON: Touch to turn on all linked lights.
Long press 5 seconds to turn ON the indicating sound.
Zone(1-4) ON: Touch Zone ON, Turn on zone-linked lights.

 ALL OFF: Touch to turn off all linked lights.
Long press 5 seconds to turn OFF the indicating sound.
Zone(1-4) OFF: Touch Zone OFF, Turn off zone-linked lights.

Link / Unlink (SM-PW1&SM-PE1,SM-PW2&SM-PE2,SM-PW4&SM-PE4)

Remark: The light can be working after linking with the remote controller.

Linking Instructions

- 1 Switch off the light, after 10 seconds switch on again.
- 2 When the light on, short press any zone of "  " 3 times within 3 seconds.
- 3 The light blink 3 times slowly means the linking is done successfully.



If the light not blink slowly, the linking failed, Pls switch off the light again, and follow the above steps again.

Unlinking Instructions

- 1 Switch off the light, after 10 seconds switch on again.
- 2 When the light on, short press "  " 5 times within 3 seconds.
(Unlinking must be the same zone with the Linking)

- 3 The light blinking 10 times quickly, means the unlinking successfully.



If the light not blink quickly, the unlink failed, pls switch off the light again, and follow the above steps to unlink again.

Link / Unlink (SM-PW3&SM-PW3)

Remark: The light can be working after linking with the remote controller.

Linking Instructions

- 1 Switch off the light, after 10 seconds switch on again.
- 2 When the light on, short press any zone of " | " 1 time within 3 seconds.
- 3 The light blink 3 times slowly means the linking is done successfully.



If the light not blink slowly, the linking failed, Pls switch off the light again, and follow the above steps again.

Unlinking Instructions

- 1 Switch off the light, after 10 seconds switch on again.
- 2 When the light on, long press " | " within 3 seconds.
(Unlinking must be the same zone with the Linking)
- 3 The light blinking 10 times quickly, means the unlinking successfully.



If the light not blink quickly, the unlink failed, pls switch off the light again, and follow the above steps to unlink again.